

**THIS DETAIL APPLIES TO METAL TRAPEZOID AND TROUGH ROOF PROFILES WITH ROOFPITCHES BETWEEN 3 AND 60 DEGREES.**

Custom

PROFILLED METAL SHEETS

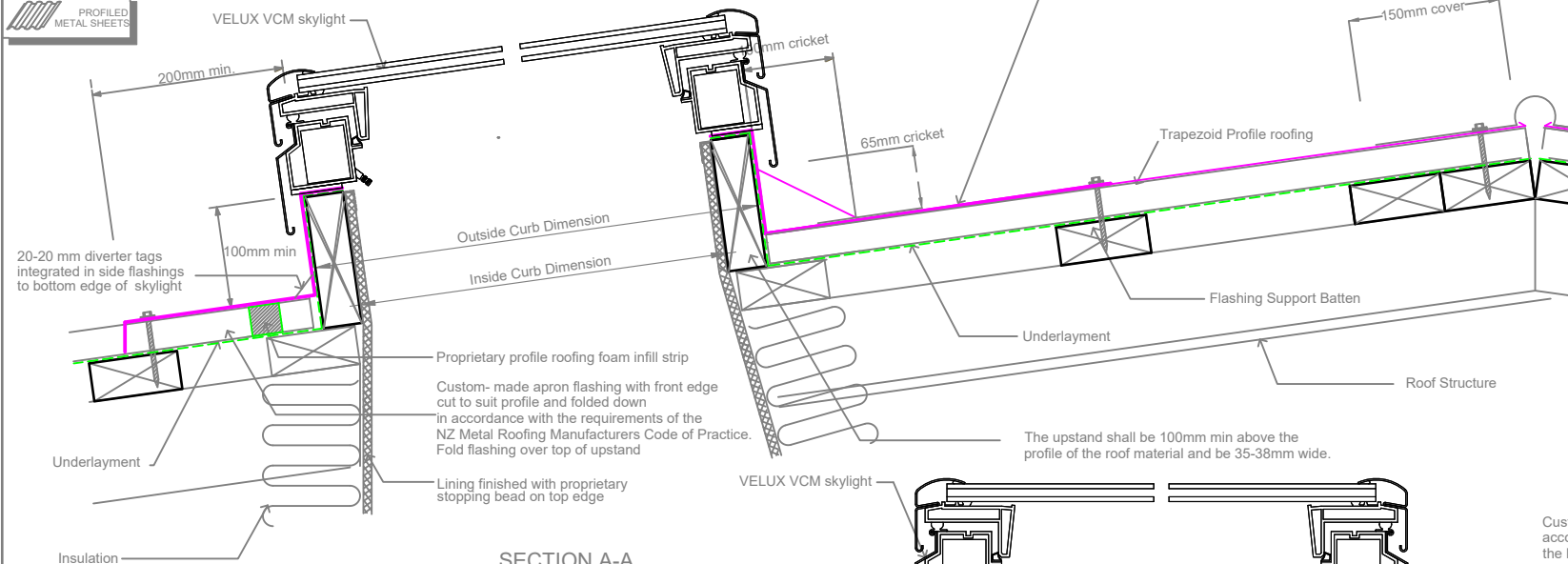

**SECTION A-A**

The upstand shall extend min. 100mm above the profile of the roof material, and be 35-38mm wide.

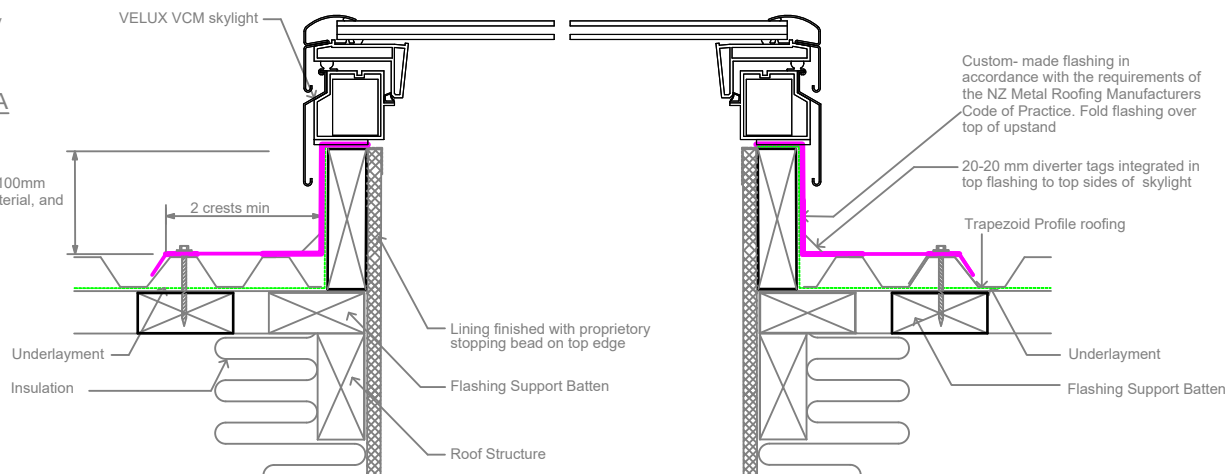

**SECTION B-B**

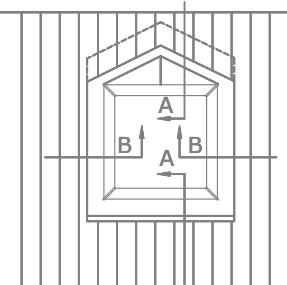

**ELEVATION**

Custom-made flashing in accordance with New Zealand Metal Roofing Manufacturers Code of Practice. Ensure all flashings meet the requirements for your projects' location.

Please note:  
Below 15 degrees:- Any condensation that forms on the glass due to high humidity may drip

## BRANZ APPRAISED CUSTOM WATER-SHED FLASHING

No cricket or diverter required when skylight is less than 600mm wide, and catchment less than 40 sqm.

Custom flashings must be designed to meet the requirements set out in the latest version of the New Zealand Metal Roof and Wall Cladding Code of Practice, and shall be manufactured and installed by a specialist flashing contractor to the latest trade practices.

The flashing and installation must be guaranteed against weathertightness by the specialist flashing contractor. Insulation material meeting the requirements of NZBC/H1 is required in the cavities of the lightwell structure.

<b>VELUX</b> Sky-Product Management	<b>NEW ZEALAND LTD.</b> 0800 650 445		Name	Date
	VELUX Low Pitch Manual Opening Skylight in Trapezoidal Steel Roof with metal water-shed flashing (3-60 degrees)		Drawn by	Feb 19
			Checked by	Feb 19
			Drawing No.	